

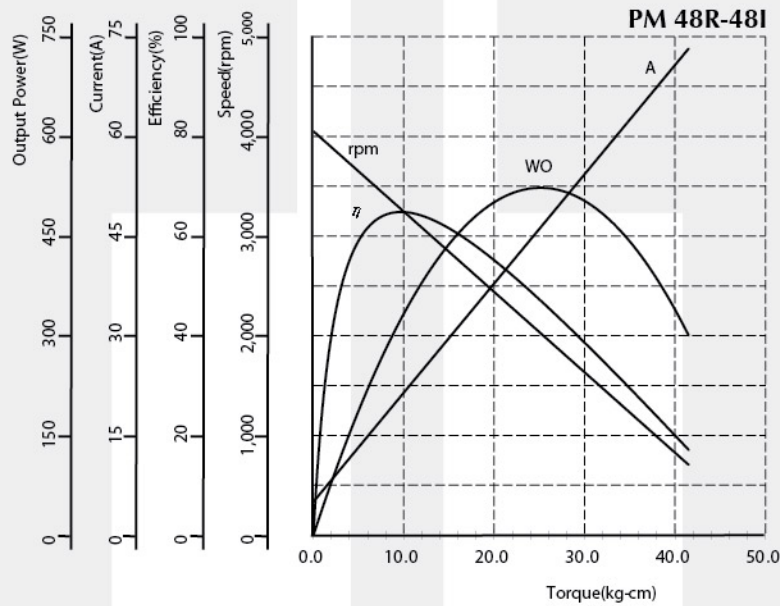

Industrial PMDC Motor - PM48R Series

Voltage : 12 - 120V DC
 Rated Speed : 600 - 3,300rpm
 Rated Torque : 9.80 - 29.30kg-cm[8.53 - 25.40lb-in]
 Rated Input Power : 300 - 2,800W
 Insulation Class : A, E, B
 Motor Diameter : $\varnothing 122.7\text{mm}$ [4.83inch]
 Typical Application : Hydraulic Pump, Vibrator, Chemical Pump

Performance Curve



Dimension (mm[inch])

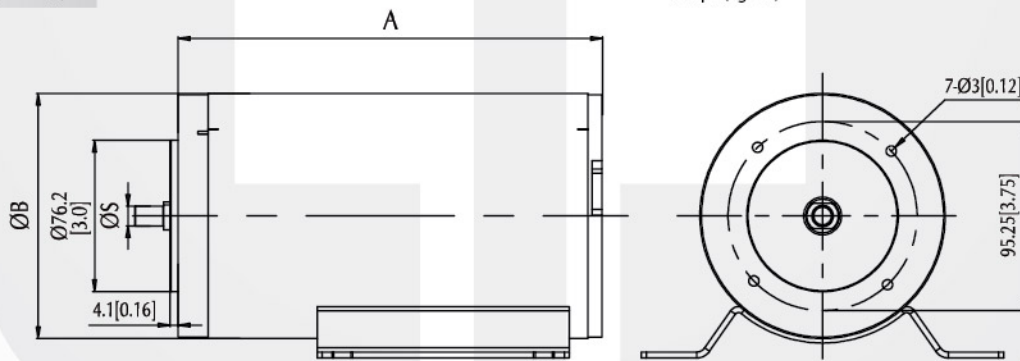

Performance (testing under room temperature)

Model	Dim A mm[inch]	Dim B mm[inch]	Dim S mm[inch]	Rated Voltage (V DC)	No Load		At Maximum Efficiency				Maximum Power			
					Speed (rpm)	Current (A)	Speed (rpm)	Current (A)	Torque (kg-cm[lb-in])	Output (W)	Speed (rpm)	Current (A)	Torque (kg-cm[lb-in])	Output (W)
PM48R-481	114.8[4.52]	122.7[4.83]	17.0[0.67]	24	4,051	5.0	3,261	21.1	9.80[8.53]	328	2,026	46.3	25.1 [21.80]	523
PM48R-951	209.6[8.25]	122.7[4.83]	17.0[0.67]	36	2,764	3.2	2,474	27.8	29.30[25.40]	744.2	1,355	106	130.0[112.83]	1809
PM48R-B5F	238.3[9.38]	122.7[4.83]	17.0[0.67]	12	1,870	5.94	1,664	47.3	24.68[21.42]	421.75	862	195	118.0[102.42]	1044.6

The information above is for reference only, detailed specification is subject to final confirmation