

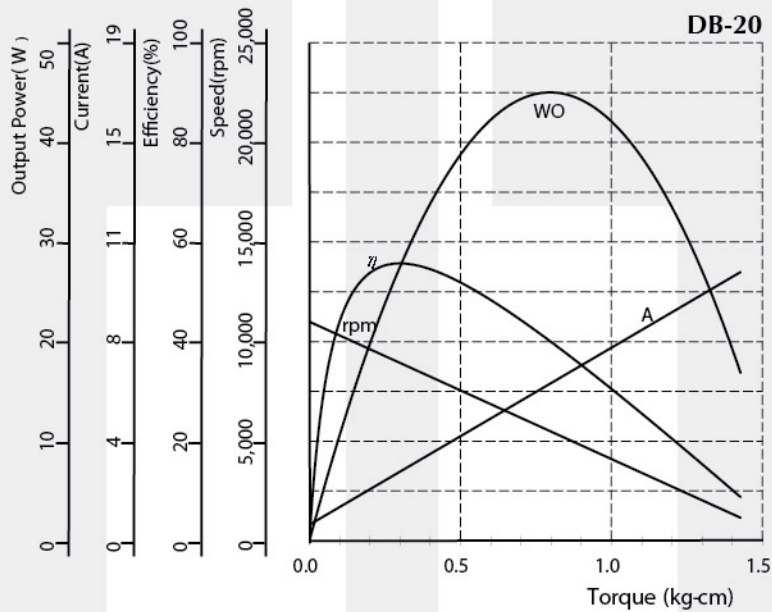

## Low Voltage PMDC Motor - DB Series

Voltage : 3 - 36V DC  
 Rated Speed : 3,000 - 20,000rpm  
 Rated Torque : 0.3kg-cm[0.26lb-in]  
 Rated Input Power : 20 - 120W  
 Insulation Class : A, B  
 Motor Diameter : Ø35.8mm[1.41 inch]  
 Typical Application : Water Pump, Air Pump, Fan, Hair Dryer, Paper Shredder, Power Brush, Vacuum Cleaner, Vending Machine

### Performance Curve



### Dimension (mm[inch])

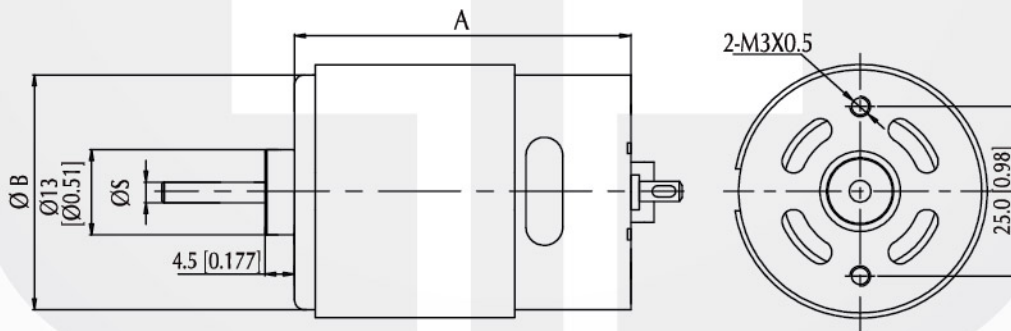

### Performance (testing under room temperature)

Model	Dim A mm[inch]	Dim B mm[inch]	Dim S mm[inch]	Rated Voltage (V DC)	No Load		At Maximum Efficiency				Maximum Power			
					Speed (rpm)	Current (A)	Speed (rpm)	Current (A)	Torque (kg-cm[lb-in])	Output (W)	Speed (rpm)	Current (A)	Torque (kg-cm[lb-in])	Output (W)
DB-20	50[1.97]	35.8[1.41]	3.175[0.125]	18	11,000	0.6	8,930	2.6	0.3 [0.26]	27.6	5,500	5.9	0.8 [0.70]	45.0
DB-30	57[2.24]	35.8[1.41]	3.175[0.125]	12	6,450	0.4	5,470	2.2	0.3 [0.26]	16.9	3,220	6.5	1.0 [0.92]	33.0

The information above is for reference only, detailed specification is subject to final confirmation

Email: sales@cclmotors.com Website: <http://www.cclmotors.com>  
 4/F, No. 6, On Lok Mun Street, On Lok Tsuen, Fanling, N.T., Hong Kong.

Tel: (852) 3125 0000 Fax: (852) 3125 0125