

Industrial PMDC Motor - PM46R Series

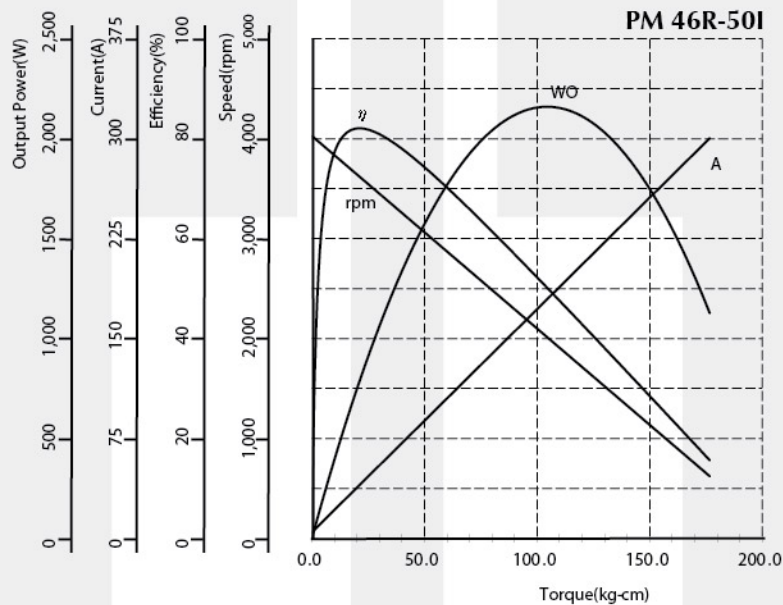

Voltage : 12 - 120V DC
 Rated Speed : 1,000 - 3,500rpm
 Rated Torque : 11.72 - 20.90kg-cm[10.17 - 18.14lb-in]
 Rated Input Power : 100 - 2,400W
 Insulation Class : A, E, B
 Motor Diameter : \varnothing 119.1mm[4.69inch]
 Typical Application : Hydraulic Pump, Polisher, Sprinkle Salt Machine, Seed/Salt Spreader

Performance Curve



Dimension (mm[inch])

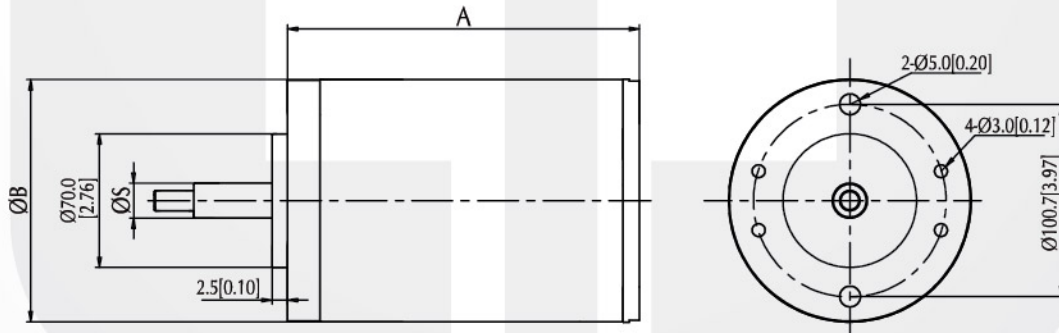

Performance (testing under room temperature)

Model	Dim A mm[inch]	Dim B mm[inch]	Dim S mm[inch]	Rated Voltage (V DC)	No Load		At Maximum Efficiency				Maximum Power			
					Speed (rpm)	Current (A)	Speed (rpm)	Current (A)	Torque (kg-cm[lb-in])	Output (W)	Speed (rpm)	Current (A)	Torque (kg-cm[lb-in])	Output (W)
PM46R-501	160[6.3]	119.1[4.69]	15.8[0.62]	24	4,028	4.5	3,625	39.5	20.90[18.14]	778.05	2,014	179.4	104.4[90.60]	2,160
PM46R-53F	164.2[6.46]	119.1[4.69]	15.8[0.62]	12	2,940	5.5	2,588	38	11.72[10.17]	311.5	1,350	175	70.0[60.76]	970.5

The information above is for reference only, detailed specification is subject to final confirmation

Email: sales@cclmotors.com Website: <http://www.cclmotors.com>
4/F, No. 6, On Lok Mun Street, On Lok Tsuen, Fanling, N.T., Hong Kong.

Tel: (852) 3125 0000 Fax: (852) 3125 0125